



## The Pitesti New Shopping Hub



Jupiter group

## The largest retail park in Arges County – Pitesti city

- ❑ 170.000 sq m plot.
- ❑ 56.000 sq m. Rentable Area
- ❑ 1.800 parking places.

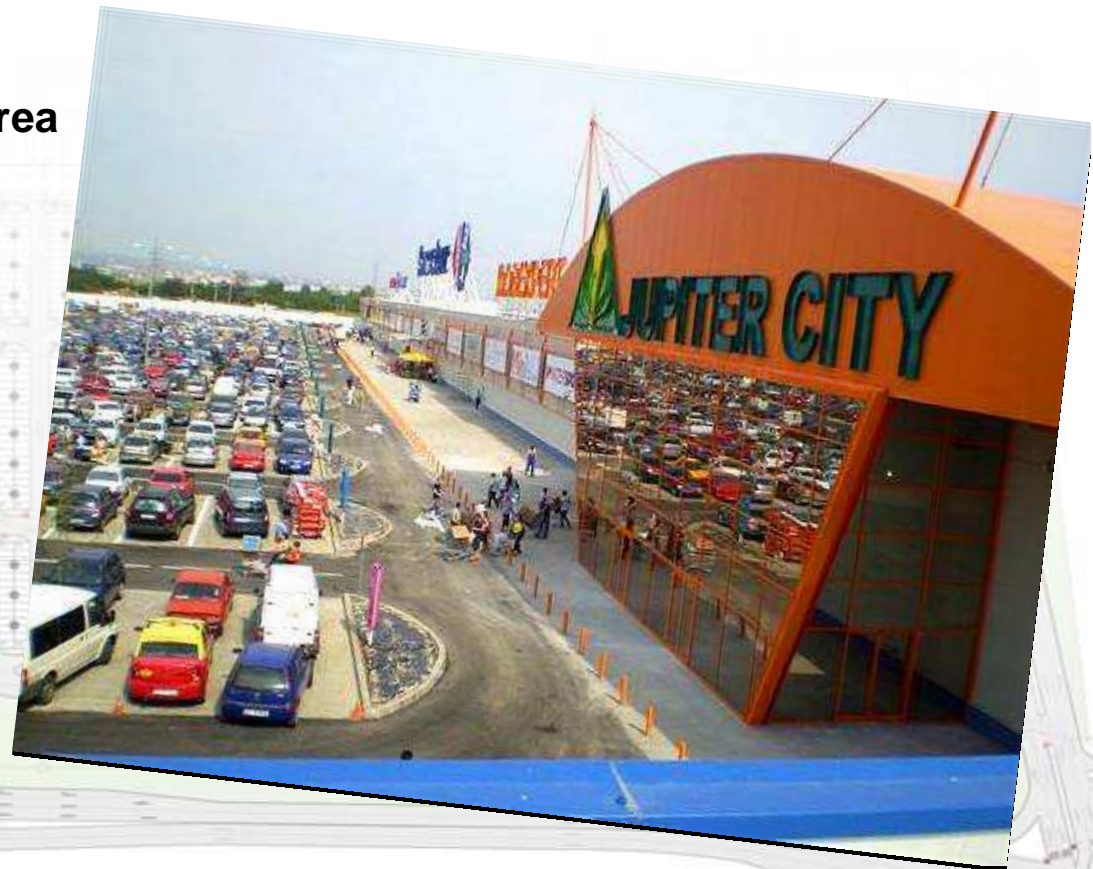



Jupiter group



**Demand**

In two months of operation Jupiter City became an area loadstone



Jupiter group



## Accessibility

- ❑ Located on the Bucharest-Pitesti Highway.
- ❑ And, on the Pan European Corridor IV - which connects Romania to west Europe.
- ❑ Full visual exposure to traffic on both highways.
- ❑ An opening of 410m. to the main road.
- ❑ 1.7 km from big residential neighborhoods.
- ❑ 3.5 km from the center of Pitesti.



Jupiter group

Designed for Success





Jupiter group

# Carrefour



Tehnologii

**Anchors**

- Carrefour
- Praktiker
- Media Galaxy
- Mobexpert



Jupiter group

MOBEXPERT

Suntem liberi să avem idei!

Leading Brands

International & local leading brands such as: Sephora, Intersport, Takko, Leonardo, Centrofarm, Steilman, Miniblu, Optiblu, Bam Boo etc'



Jupiter group



**Designed  
for leisure**

- ❑ Full customer services : Banking, Pharmacy and nature shop, children's facilities, range of restaurants and coffee shops.
- ❑ Service road & loading zones.
- ❑ An incremental - market growth - approach.
- ❑ Master plan: Chapman Taylor (CT), the largest firm that specializes in retail, with forty years of experience in the European Region.

Master Plan

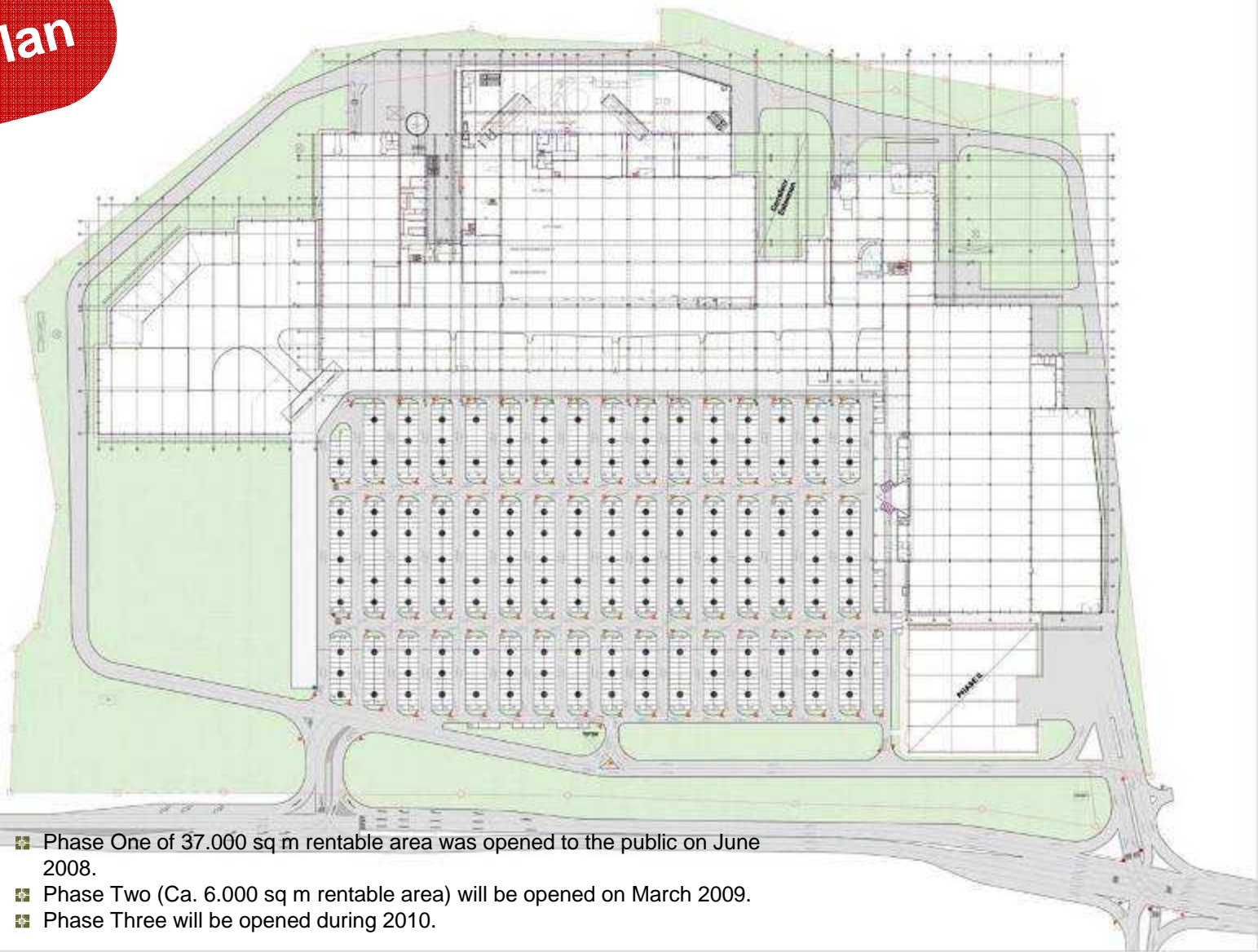

 Nord  
 - linii de delimitare a terenului  
 - linii de delimitare a loturilor  
 - linii de delimitare a terenurilor  
 - linii de delimitare a terenurilor  
 - linii de delimitare a terenurilor

S.C. JUPITER PITEȘTI S.R.L.  
 Complex Comercial **BRADU PITEȘTI**  
 ARHITECTURA  
 PLAN DE ÎNCADRARE  
 MODIFICAT  
 COMENTARII  
 100  
 1:250  
 D

- Phase One of 37.000 sq m rentable area was opened to the public on June 2008.
- Phase Two (Ca. 6.000 sq m rentable area) will be opened on March 2009.
- Phase Three will be opened during 2010.



Jupiter group







Jupiter group

Location Map





Jupiter group

## The Team

### Jupiter Group - Developer

100% subsidiary of a multinational well-known real estate developer.

- Experience of over 20 years.
- Active in all Europe & the Middle East.
- Proven track record of:
  - Several shopping malls, with over 180.000 sqm of rentable area.
  - Residential projects, Office buildings, Logistic & light industry parks.
- Has been engaged in various projects in Romania - 250 million Euro value.
- The Group's large capital together with a track record of successful shopping centers, ensures success.

65, Sf. Voievozi Street, Bucharest, Romania

Phone: 0040-31-640.64.00

Fax: 0040-21-650.40.11

office@jupitergroup.ro

[www.jupitergroup.ro](http://www.jupitergroup.ro)

[www.jupitercity.ro](http://www.jupitercity.ro)



Jupiter group

## The Team

### Retail Group – Leasing Agent



- ❖ Retail Group is a company exclusively specialized in renting and planning of commercial centers and malls.
- ❖ It was established in 2006 and it's composed by a team of professionals led by Ilan Laufer, ex-sales manager of Winmarkt, the biggest commercial centers network in Romania.

77 Dobrogeanu Gherea Street, 4th Floor, ap. 10, Sector 1  
Bucharest, Romania  
Phone: 0040-31-425.42.55

[office@retailgroup.ro](mailto:office@retailgroup.ro)  
[www.retailgroup.ro](http://www.retailgroup.ro)



Jupiter group

We thank you